



HOLISTIC HEALING: WHERE ARCHITECTURAL QUALITIES AND SPATIAL EFFICIENCY MEET

RICHARD DELAROSA, ARCHITECTURE // DR. ALEXANDER ORTENBERG // KELLOGG HONORS COLLEGE CAPSTONE 2012



BACKGROUND INFORMATION

- AS CLIMATE CHANGE BECOMES A PRESSING ISSUE TOWARDS THE TREND OF RISING SEA LEVELS AND CLIMATE REFUGES, HUMAN LIFE CAN BE DRAMATICALLY IMPACTED BY THE AMOUNT OF DISASTER LIFE SUPPORT SYSTEMS.
- WITH MILLIONS OF PEOPLE AROUND THE WORLD OFTEN DEVASTATED BY THE POWER OF NATURE, THERE IS A GREAT NEED FOR THIS TYPE OF MEDICAL SHIP.
- THE US EXISTING INFRASTRUCTURES FOR THE MERCY-CLASS SHIPS ARE QUITE DILAPIDATED AND THERE IS A LARGE AMOUNT OF CRITICISM AS TO HOW EFFICIENTLY IT IS ADMINISTERED.
- MANY TIMES, LOCAL AGENCIES SUFFER DEBILITATING EFFECTS OF TSUNAMIS AND HURRICANES, ESPECIALLY IN DEVELOPING NATIONS. ONE THING IS CLEAR, NATURE IS NOT DISCRIMINATORY.

STUDY OBJECTIVE

- REFURBISH AN EXISTING OIL TANKER TO HELP MEET EXISTING NEEDS OF PEOPLE WHOM SUFFER FROM LACK OF HEALTHCARE AND TREATMENT.
- INTEGRATE THE USE OF WATER AS A METHOD FOR HEALING. THE PROGRAMS I WILL BE SHOWING ARE VARIATIONS BASED ON A GENERAL LIST.
- RELATE BOTH CONTEXT AND PROGRAM WITH SUFFICIENT ANALYSIS IN ORDER TO INTERCONNECT, FUNCTIONING THE BODY TO THE WHOLE.



DERIVED PROGRAM

SOFT PROGRAM

9,000	PUBLIC AREA, REGISTRATION, AND EDUCATION
60,180	CLINIC-EXAM ROOM AND TREATMENT COMPONENT
8,200	ANCILLARY SERVICES COMPONENT
6,900	BUSINESS AND HUMAN RESOURCES COMPONENT
15,180	AMBULATORY SURGERY COMPONENT
10,140	OUTPATIENT REHABILITATION COMPONENT
28,020	MECHANICAL, NAVIGATION, AND SUPPORT AREAS

137,620 TOTAL SHIP GROSS AREA

OCCUPANCY RATIO
TOTAL STAFF TO PATIENT RATIO = 2:3

SCALED RELATION FIGURE

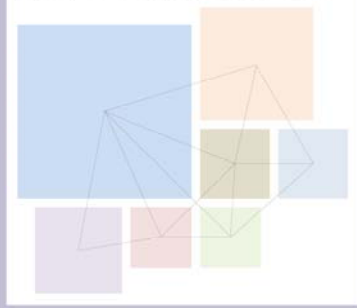

WATER EXAMPLES



SPACE EXAMPLES

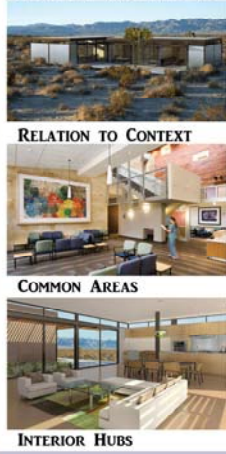

SHIP EXAMPLES



OBSERVATION OF SENSES TRANSLATED INTO STRUCTURE

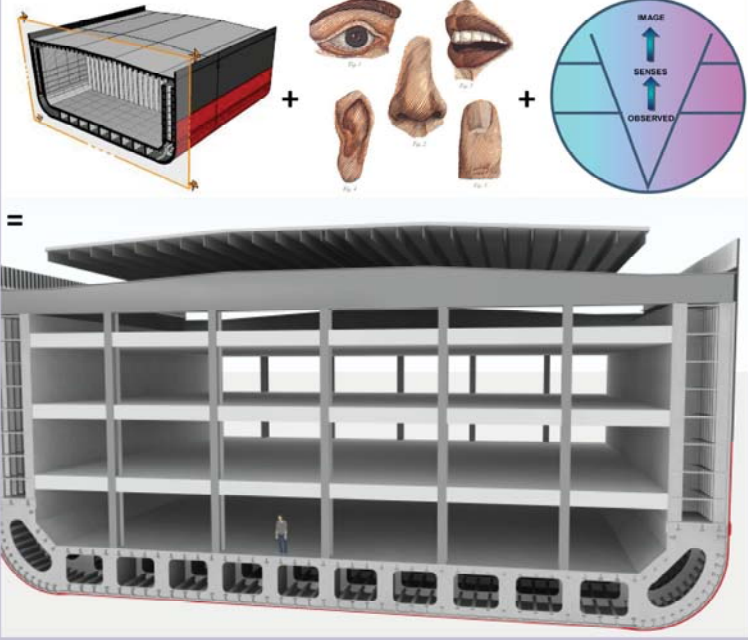

LEGEND

PUBLIC AREA, REGISTRATION & EDUCATION

THE SPACES MAIN INTENT IS TO PROVIDE FOR THE DISPLAY AND PROVIDE HELP FOR GUEST SERVICES. THE MAIN HUB IS A PUBLIC SPACE DESIGNED TO FACILITATE THE ACCESS FOR EVERYONE. BECAUSE OF THE NUMEROUS FLOW TRAFFIC THAT GOES THROUGH HERE, THERE IS A LARGE MOVEMENT OF VOLUMES OF PEOPLE. THE HUB MUST BE PLANNED TO ACCOMMODATE SUCH EVENTS. FURTHERMORE, THE EDUCATION SPACE WILL HAVE TO BE MORE THAN A SPACE WHERE PEOPLE LEARN, IT WILL HAVE SEVERAL OTHER FUNCTIONS SUCH AS HAVING SEATING SPACES TO ALLOW FOR PEOPLE WATCHING AND SOCIALIZING. WORKING ON THE OUTSKIRTS OF A FOREIGN LAND CAN EASILY BE DAUNTING UPON ARRIVAL. WITH THE ONSET OF INCOMING USERS, THERE MUST BE A CONTROLLED YET INDIRECT MESSAGE AS ONE PASSES THROUGH THE SUBSEQUENT SPACES.

CLINIC - EXAM ROOM & TREATMENT

THE PROGNOSIS PART OF THE SYSTEM, USED TO TREAT MINOR INJURIES, AS WELL AS DIAGNOSIS EXISTING PROBLEMS FOR MANY INCOMING PATIENTS. THIS REALLY NEEDS TO ACCOMMODATE BOTH INTERVIEWS WITH PATIENTS AND FACILITATE BASIC HEALTHCARE PACKAGES. FURTHERMORE, THESE SPACES ARE ESSENTIAL IN THE CREATION OF A STRONG SENSE OF SAFETY IN AN OTHERWISE FOREBODING ENVIRONMENT. A MAJORITY OF PROBLEMS WILL BE ADDRESSED HERE FOR THE SAFETY OF THE PUBLIC, BECAUSE THIS IS THE MOST LIKELY TO BE USED BY BOTH PARTIES, MOST OF THE AQUA THERAPEUTIC APPROACHES WILL BE FOCUSED IN THIS AREA PRIMARILY.

ANCILLARY SERVICES COMPONENT

AS THE NAME SUGGESTS, ANCILLARY, MEANING AUXILIARY, OR SUPPORTIVE SERVICES IS USED TO TIE THE CLINIC ROOMS TOGETHER WITH COMMUNAL MACHINES SUCH AS A DIGITAL R/F ROOM, BONE DENSITOMETRY ROOM, EMG ROOM, ETC. THERE IS BIG EXPECTATIONS FOR THIS CERTAIN PART OF THE PROJECT. IT IS ONE OF THE MOST NEGLECTED PARTS OF A HOSPITAL AND COULD VERY WELL SERVE AS A CRUCIAL LINK BETWEEN THE THERAPEUTIC EFFECTS OF WATER AND DESIGN. INCORPORATING WATER FEATURES WILL HELP PROMOTE THE HEALING PROCESS.

AMBULATORY SURGERY COMPONENT

THIS SPACE WILL BE PRIMARILY OPEN IN PLAN SO THAT FUTURE USERS MAY CUSTOMIZE IT TO THEIR INDIVIDUAL NEEDS. THIS SPACE IS DESIGNED FOR THE VARIOUS NEEDS OF SURGEONS AND SURGICAL EQUIPMENT. THESE NEEDS INCLUDE A SAFE PLACE TO STORE BELONGINGS AND MEDICINES/ANESTHESIA. ARGUABLY THERE IS AN EMPHASIS TO KEEP THESE ENVIRONMENTS THE MOST "CONTROLLED." UNLIKE OTHER COMPONENTS, THIS VARIES IN SIZE ACCORDING TO THE TYPE/COMPLEXITY OF THE OPERATION. PRIMARY USERS OF THE SPACE WILL BE PATIENTS WHOM ARE ONGOING SURGERY, AS WELL AS THE SURGICAL STAFF AND CRITICAL CARE NURSES.

BUSINESS & HUMAN RESOURCES COMPONENT

THE OFFICE IS DEDICATED FOR THE NEEDS OF THE ADMINISTRATION. THIS WOULD INCLUDE FILE STORAGE SPACE, DESKS, AND SEVERAL COMPUTERS. MORE IMPORTANTLY, IT CAN BE SEEN AS THE HEART OF THE SHIP AS ALL DIRECTION OF OPERATION COMES FROM THIS AREA. THERE WOULD PRIMARILY BE THOSE THAT LIVE ON THE SHIP, HIGH RANKING OFFICERS, AS WELL AS ADMINISTRATION WOULD ALSO BE VIABLE CONSIDERATIONS AS THE MAIN "USERS" OF THIS SEGMENT.

OUTPATIENT REHABILITATION COMPONENT

THE THERAPY AND SUPPORT. USED PRIMARILY AFTER PROGNOSIS, DIAGNOSIS, SURE AND CRITICAL RECOVERY. IN ADDITION, IT CAN HOUSE BOTH MORE EASY TREATMENT ALTERNATIVES AND WOULD INCLUDE FEATURES THAT INCORPORATE THE USE OF WATER IN THE DESIGN. THE PRIMARY USERS OF THIS WOULD BE THOSE WHO HAVE BEEN IN POST OPERATION AS WELL AS SPECIFIC "REHABILITATION STAFF" THAT PRIMARILY CATER TO THIS PROGRAM. SOME EXAMPLE UNITS OF THIS COULD BE MODALITY BOOTHS

MECHANICAL, NAVIGATION, & SUPPORT AREAS

THIS CAN BE SEEN AS NECESSARY YET SECONDARY AREAS. SPACE DESIGNED TO FACILITATE THE MAIN MOVEMENT OF SHIP AND CONTROL ENVIRONMENTS. THE SECONDARY AREAS INCLUDE OTHER SUPPORTING FACILITIES NECESSARY FOR A COMMUNITY TO FUNCTION. THESE AREAS USUALLY INCLUDE MAINTENANCE ON THE SHIP ITSELF, AS WELL AS PLACES OF REST FOR THE PERMANENT RESIDENCE ABOARD THE SHIP. SOME PERFECT EXAMPLES OF THIS WOULD INCLUDE SMALLER COMMUNITY SUPPORTING FACILITIES SUCH AS STAFF QUARTERS LAUNDRY, AND KITCHEN. THE WHILE EVERYONE ON BOARD WOULD KNOW SAFETY PROCEDURES, THERE IS A PERMANENT CAPTAIN AND CREW THAT WOULD PRIMARILY BEING THE SHIP TO PORT. THEY WOULD BE THE FINAL "USERS" OF THE GROUP OF SEVEN.



OPTION 1 : SCATTERED

PROGRAM // A RANDOM ENCOUNTER, WITH SURPRISING RESULTS THIS CONFIGURATION AIMS TO CREATE PEDESTRIAN POCKETS THROUGH THE CORRIDORS. THERE IS A CLEAR DISTINCTION BETWEEN THE THREE PRIMARY USERS. THE MAIN ASPECTS OF WHICH ARE PATIENT, MEDICAL STAFF, AND SUPPORT. THE ARRANGEMENT AIMS TO CREATE RESTING POCKETS FOR THE ANXIOUS TRAVELER. THE BAYS CREATE INCENTIVES FOR INDIVIDUALS TO ENJOY THE AVAILABLE WATER FEATURES AND AMENITIES FOUND THROUGHOUT THE PROJECT. THE PUBLIC LOBBY IS VERY OPEN, THIS CONFIGURATION HELPS CREATE A CONTRAST BETWEEN THIS OPENNESS WITH A FEW MORE PERSONAL SPACES.

NARRATIVE // BY DECENTRALIZING COMMON DESTINATIONS, THIS BUILDING MAKES TRAVELING THE LENGTH OF THE PROJECT OFF BEAT, FOLLOWED THEN BY TRAVELLING PERHAPS UPWARDS THROUGH PROGRAM.

DESTINATION// IT IS INEFFICIENT UNLESS SOMEONE HAS MULTIPLE PURPOSES IN THE BUILDING, THEN DISTANCES ARE SIGNIFICANTLY DECREASED.

PROS // IT WILL BE VERY EFFICIENT FOR PEOPLE ARE CONSTANTLY THERE

CONS // THERE IS AN ADVERSE EFFECT FOR FIRST TIME USERS. THEY MAY EXPERIENCE GETTING LOST EASILY.

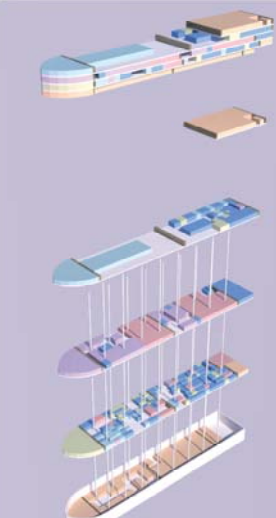

OPTION 2 : CENTRALIZED

PROGRAM // ORGANIZED INTO ROWS, MOVEMENT AND CIRCULATION ARE EMPHASIZED IN SECTION. THIS CONFIGURATION AIMS TO BLEND THE GATHERING SPACE THROUGH THE SITE SO THAT THE GATHERING SPACES BECOMES MORE OF A COMMUNAL SPACE FOR THE HULL. THE LARGER CLINIC AREAS IS LOCATED TOWARD THE SIDES TO RECEIVE AN EVERLASTING VIEW OF THE OUTSIDE. THIS IS NECESSARY BECAUSE IT ALLOWS MORE CONTROLLED ENVIRONMENTS TO LOCATED IN THE INNER CORE OF THE SHIP. SEPARATING THE TWO SEGMENTS OF ANCILLARY SYSTEMS IS SUBJECT TO DEBATE AND ALSO REQUIRES FURTHER ANALYSIS.

NARRATIVE // ALTHOUGH THE MECHANICAL ELEMENTS HAVE NOT CHANGED, COLLECTIVE SPACES ARE SEPARATED ONTO SEPARATE FLOORS, THE GUEST INEVITABLY EXPERIENCES BOTH EFFICIENCY WHILE KEEPING CONSTANT RHYTHM FROM START TO FINISH.

DESTINATION// FROM START TO FINISH THE GUEST MUST TRAVEL IN SECTION BU DO HAVE A CHOICE TO GET TO THE PROGRAM THEY NEED WITHIN THE PROJECT.

PROS // BLOCKS OF AREAS MAKE IT ACCESSIBLE, ALLOWING A GREAT AMOUNT OF EFFICIENCY WITHIN THEIR LOCATIONS

CONS // SIMILAR TO SPECIALIZING, LONG HALLWAYS MAKE IT IMPARTIAL TO THE USER.

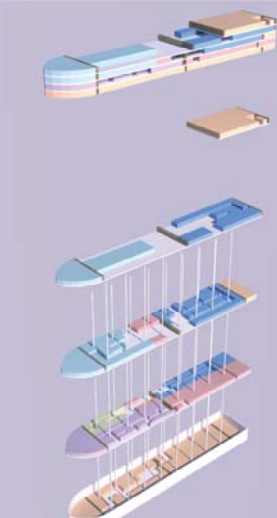

OPTION 3 : HYBRID

PROGRAM // BEINGS ON THE STERN END AND CULMINATES AT THE STARBOARD END IN A LINEAR FASHION (IN PLAN). UNDUPLICATION OCCUR IN SECTION. THIS CONFIGURATION IS BASED ON THE IDEA OF HAVING THE ENTIRE PROGRAM COMBINED INTO ONE STRUCTURE. THE PROGRAMS WOULD BE SCATTERED AROUND THE ENTIRE SITE TO CREATE A MORE HOMOGENEOUS STRUCTURE. SOME PROBLEMS WITH THIS APPROACH ARE ESTABLISHING A SENSE OF COMMUNITY WITHIN THIS SUPER STRUCTURE. THERE NEEDS TO BE FURTHER ANALYSIS AS TO HOW THE PROGRAMS GET DISTRIBUTED THROUGH THE HULL IN A LOGICAL AND SYSTEMATIC WAY. ONCE AGAIN THE SUPPORT SERVICES ARE LOCATED AT FIXED LOCATION OUT TO SENSIBLE CRITERIA.

NARRATIVE // THE CENTER ITSELF IS THE COMMON SPACE PROVIDING SUFFICIENT ISOLATION AS WELL AS CONSTANT OPPORTUNITIES TO OVERLAP AT MOMENTS SOME MOMENTS HAVE POCKET SPOTS WHERE PEOPLE CAN TAKE A BREAK FROM "THE REALITY OF THE SITUATION"

DESTINATION// GUESTS TRAVEL FROM THE CENTER TO THE ENDS, ARE TO EXPERIENCE ONE WHAT THEY ARE LOOKING FOR.

PROS // EASILY ACCESSIBLE.
CONS // NOT TOO EXCITING IN PROGRAM.

