

1. SHARED RESOURCES CLASSROOM LIBRARY ADDITION

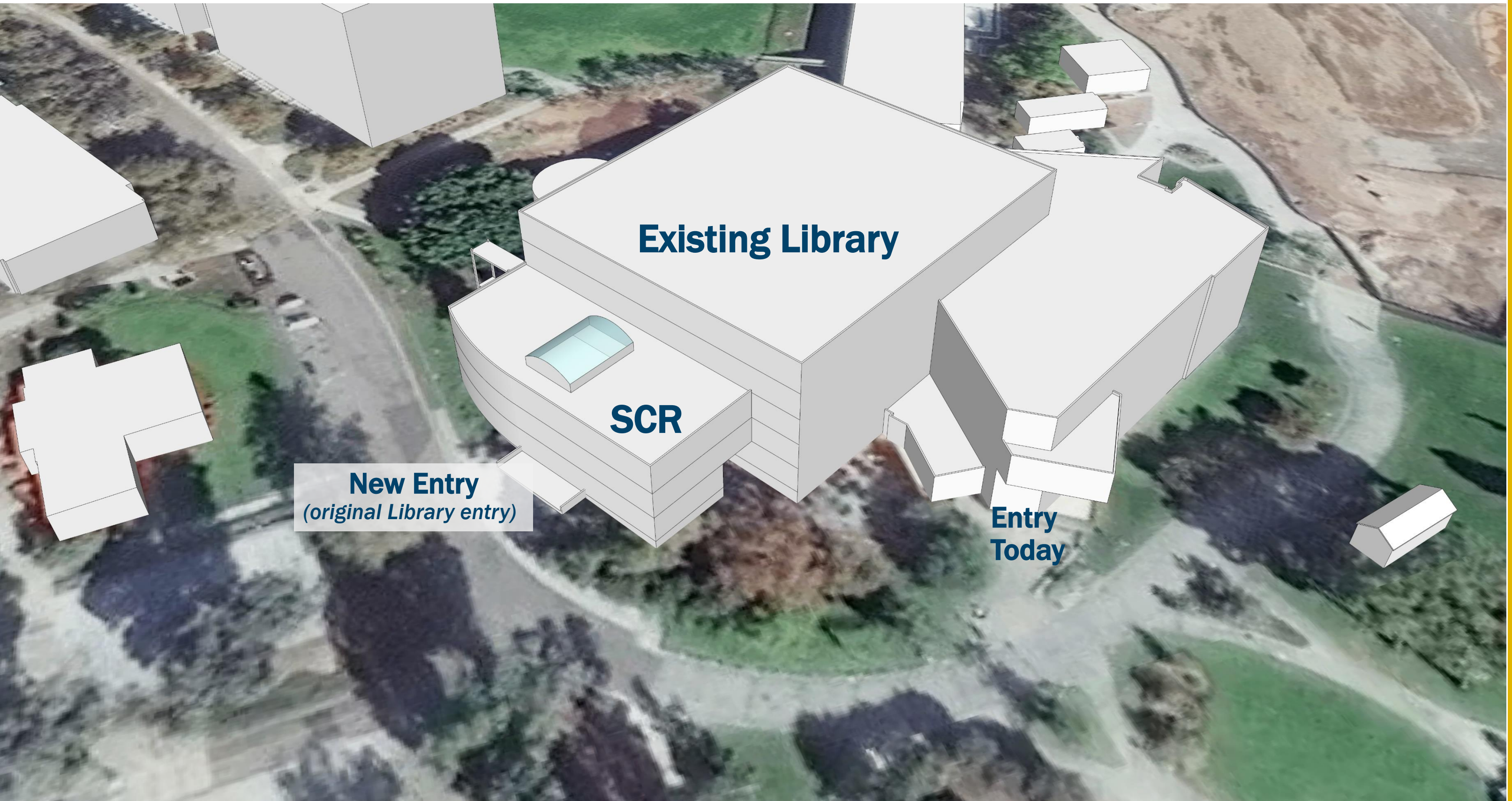

SHARED CLASSROOM RESOURCES/LIBRARY ADDITION

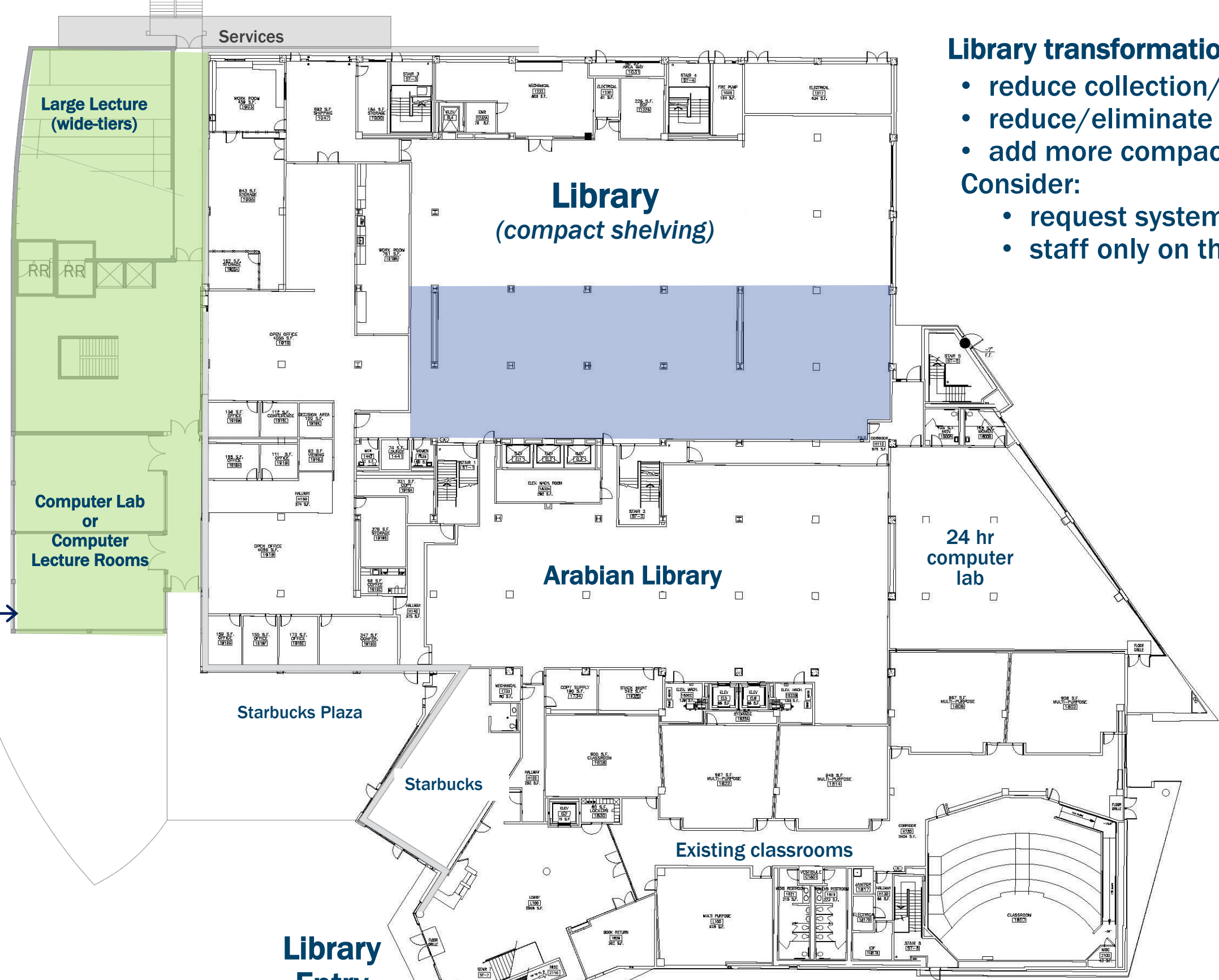

Library transformation includes:

- reduce collection/materials
- reduce/eliminate stacks
- add more compact shelving

Consider:

- request system for books
- staff only on the lower level

New Building Lower Level

This space could be an additional 24 hr computer lab at peak times →

- New Addition**
- Library Transformation**

Library Entry today

LIBRARY FIRST FLOOR

SHARED CLASSROOM RESOURCES/LIBRARY ADDITION

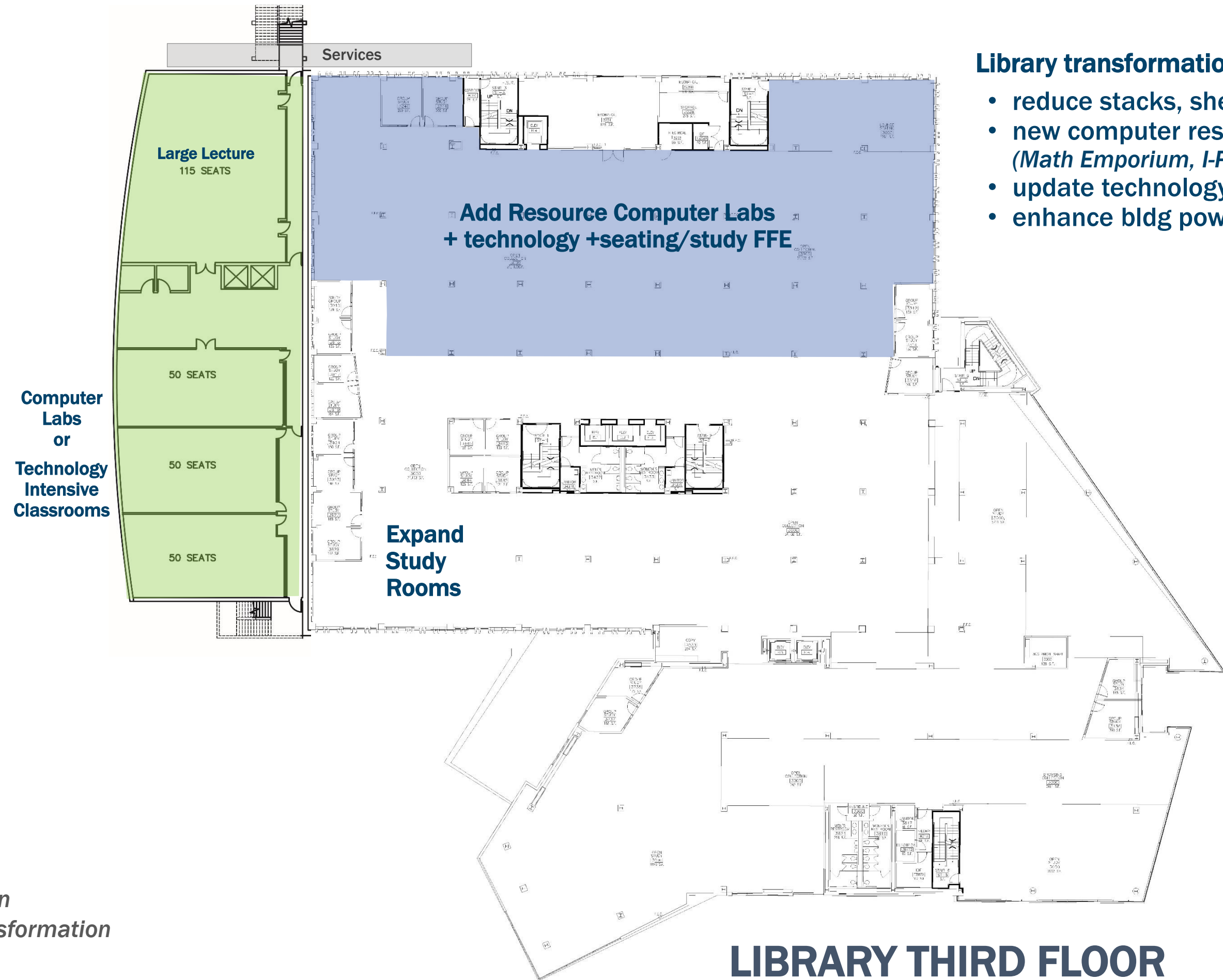

Library transformation includes:

- reduce stacks, shelves
- new computer resources labs (*Math Emporium, I-Poly, Mac, etc.*)
- update technology, seating
- enhance bldg power, services

- New Addition
- Library Transformation

LIBRARY THIRD FLOOR

SHARED CLASSROOM RESOURCES/LIBRARY ADDITION

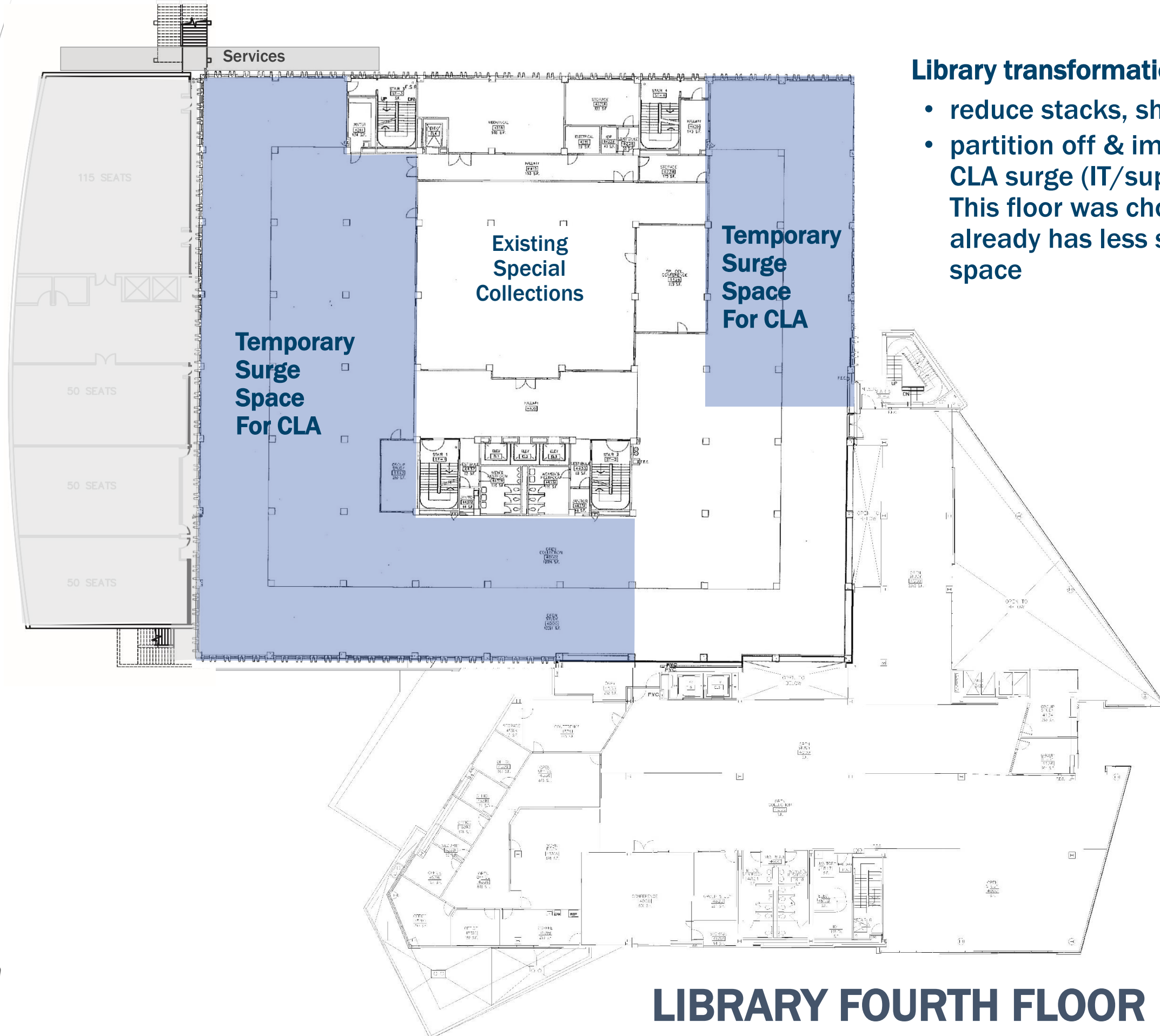

Library transformation includes:

- reduce stacks, shelves
 - partition off & improve space for CLA surge (IT/support offices)
- This floor was chosen because it already has less student study space

-  **New Addition**
-  **Library Transformation**

LIBRARY FOURTH FLOOR

SHARED CLASSROOM RESOURCES/LIBRARY ADDITION

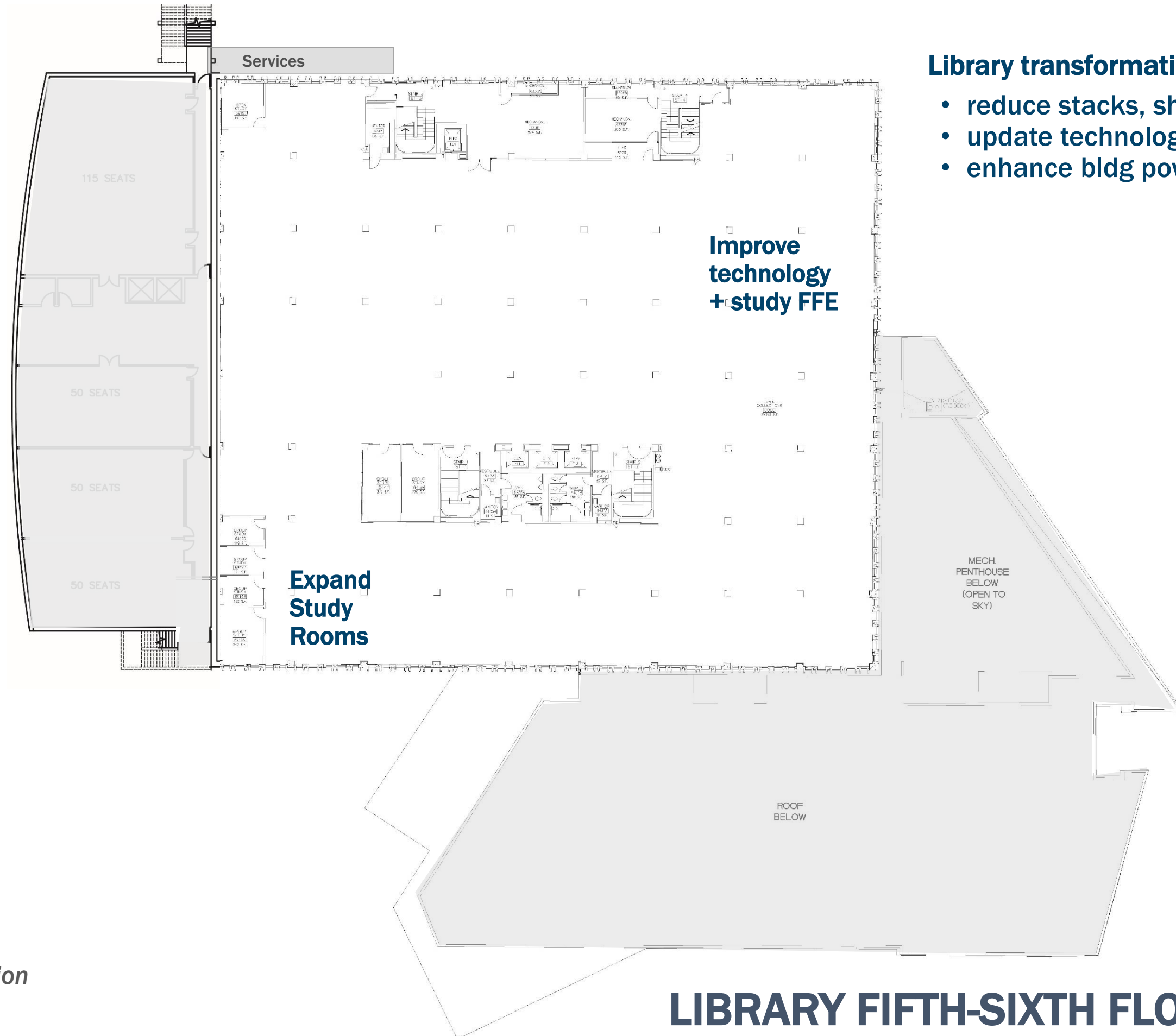

Library transformation includes:

- reduce stacks, shelves
- update technology, seating
- enhance bldg power, services

-  New Addition
-  Library Transformation

LIBRARY FIFTH-SIXTH FLOORs

SHARED CLASSROOM RESOURCES/LIBRARY ADDITION

Totals

Surge Space Needs for CLA Project:



- 19,000 gsf
 - 7,500 gsf lecture
 - 14,000 gsf computer labs
 - 4,500 gsf computer resource labs
 - 750 seats/stations min needed
- 40,000 gsf temp IT/Admin support space
 - 10,000 studio/media space
 - 20-30,000 open office space (verify #s)

New Addition:

- 20,000 gsf total
- 6-7,000 gsf/floor
- 3 floors
- Classrooms (large, over 100 seats)
- Computer labs (incl potential 24/7 lab)

Renovation:

- 40,000 gsf renovated student space
 - 3,000 gsf computer class labs
 - 5,000 gsf computer resource labs
 - 32,000 gsf for LRC, LC and study areas
- 40,000 gsf temp IT/Admin support space
- Add power, data, HVAC capacity to library

-  New Addition
-  Library Transformation

SECTION E-W

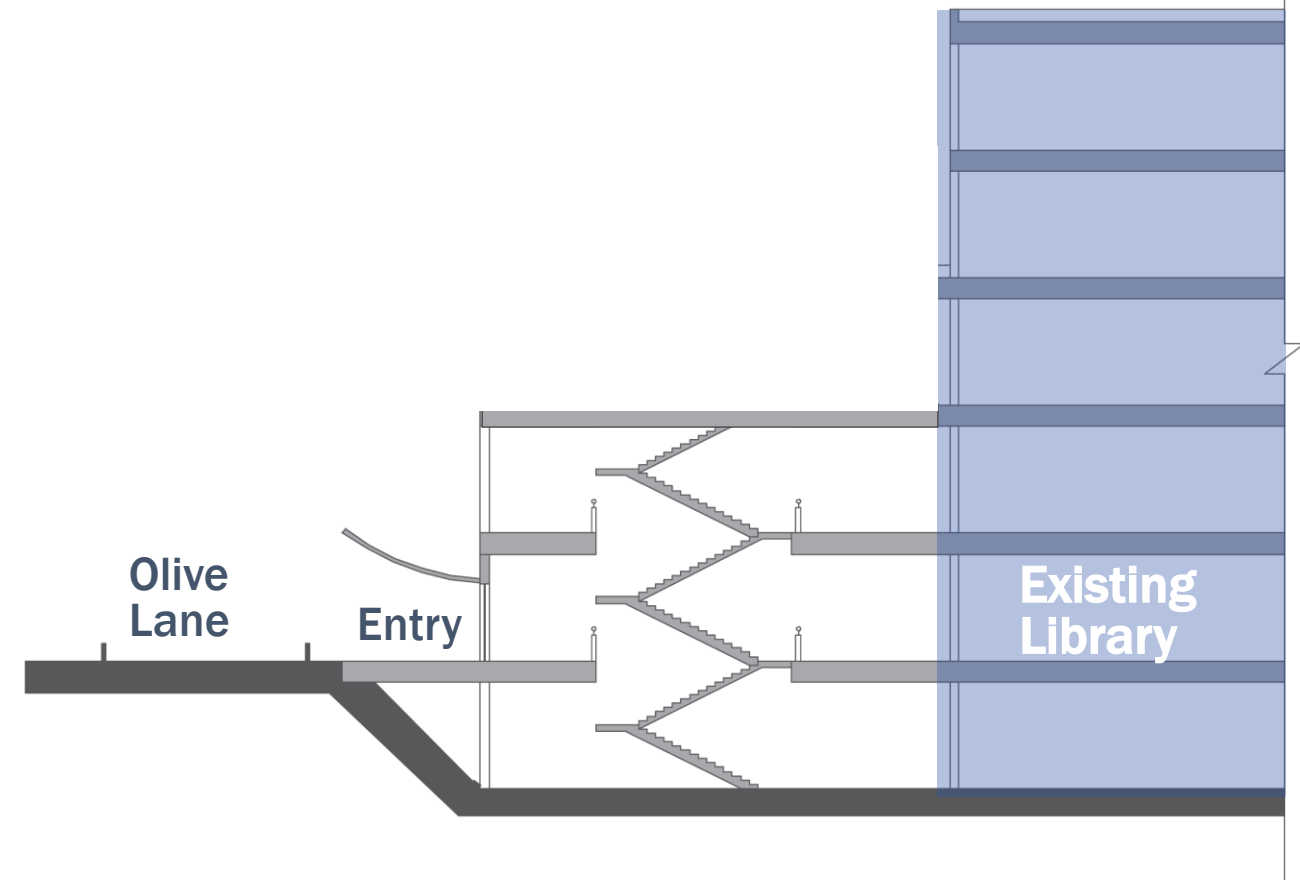

SECTION N-S

