



# Shade + Seating

## Input from the Student Open House @ the BSC

California State Polytechnic University, Pomona Master Plan Update



November 29, 2018 – Student Open House @ the BSC





# CONTENTS

---

## **1. Task Charge**

## **2. Engagement**

- a) ASI – BSC Facilities + Operations Committee**
- b) Student Survey/Open Forum**
  - Set-up + Process
  - Participation Statistics
  - Student Comments

## **3. Data Analysis**

- a) Shade & Seating locations campus-wide**
- b) Shade & Seating around the BSC**
- c) Shade & Seating Preferences**
- d) BSC Improvement Priorities**

## **4. Strategies + Concepts**

# TASK-CHARGE

---

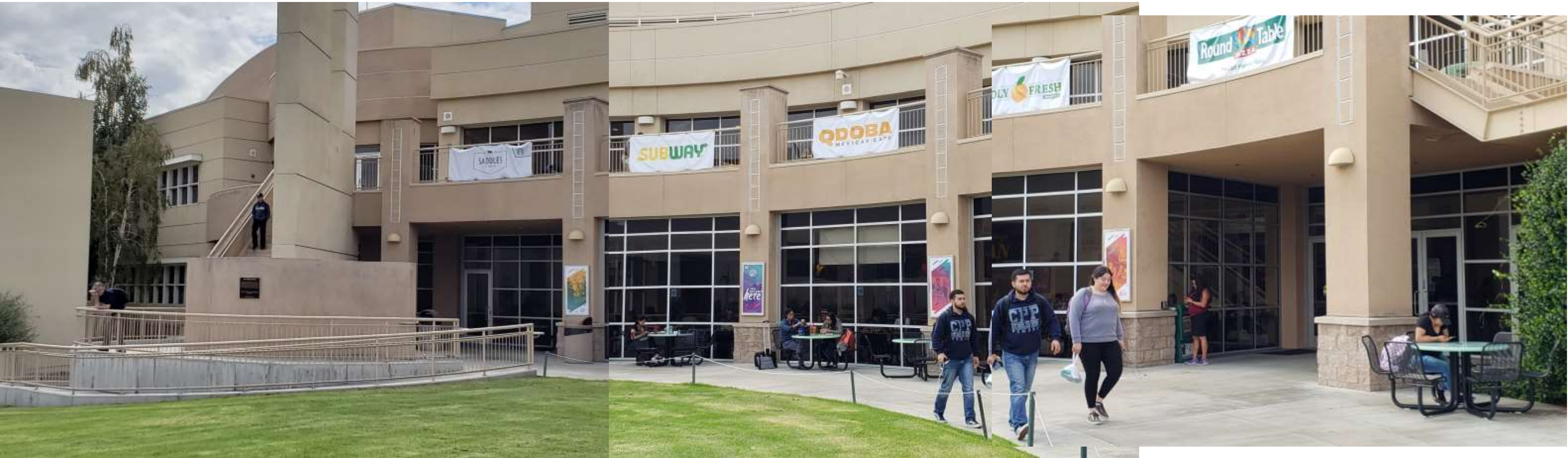

## Proposed planning/design process:

- ✓ **Meet with staff and stakeholders** -- *start w/ASI Facilities + Operations Committee (suggest a 'working group' to manage the process)*
- ✓ **Investigate options + constraints** - especially for shade structures (*existing subsurface structures or utilities, etc.*)
- ✓ **Facilitate an open workshop** to gain additional input from students, staff, faculty
  - challenges/opportunities (*BSC in general*)
  - priorities exercise for plaza project
  - survey visual preferences for furnishings and shade structures
- **Document workshop input and share with stakeholders**  
*(ASI F+O Committee, Foundation, CPP Planning + Facilities, MP Advisory Committee, format to post on MP and ASI websites)*
- **Develop design concepts** (*with alternatives as appropriate, review with the working group to identify preferred concept*)
- **Present the proposed concept** (*with a cost estimate + documentation of the process and student input*)





## **Proposed BSC Study process:**

- ✓ **Data gathering** about the use of the BSC, including changes in use over time, and analysis of actual utilization (vs perceptions)
- **Investigation of the existing BSC building and systems** to inform assumptions about expansion options and planning studies
- **Sketch studies for BSC expansion** including how the BSC relates to University Park, bookstore, etc.
- Sketch studies for proposed parking structure behind the BSC (west side) and conference center space on the upper level, including feasibility of connecting the new space to the BSC upper level
- Study potential to improve the south end of the BSC, facing the multi-use mall (Eucalyptus Lane) by shifting access to some service and dock functions currently on the south end of the building
- **Facilitate input from stakeholders** with focus sessions and work shops, starting with the plaza shade/seating workshop and continuing to work with the ASI F+O Committee, MP Executive and Advisory Committees.
- **Present the preferred approach** to BSC improvement and expansion, along with study findings, the planning process and a range of likely cost, for leadership consideration and inclusion in the master plan.



Campus-wide:

Students express an appreciation of the campus spaces, but the lack of shade limits their ability to use those spaces.

Lack of shade also constrains turnout at student events, impacting student engagement.





# STUDENT ENGAGEMENT





# OPEN FORUM SET-UP

<http://polycentric.cpp.edu/2018/12/students-give-input-on-bsc-campus-seating-at-master-plan-open-forum/>





# 63

## Total Students Participated

electrical engineering, chemical engineering, mechanical engineering, civil engineering, electromechanical engineering technology, computer science, biology, chemistry, agriculture, journalism, communications, management and human resources, dietetics, food and nutrition, architecture, urban planning, finance + real estate, pre-law, pre-vet, music, english and english lit, business, geology, kinesiology, anthropology, lpoly



# STUDENT ENGAGEMENT





# WHAT WAS ASKED

## **Students were asked questions related to the campus:**

- Where do they study?
- Where do they socialize?
- Where do they want and/or need more seating? and more shade?
- ‘Likes & dislikes’ about specific seating and shade elements

## **Students were asked questions related to the Bronco Student Center:**

- How much time do they spend at the BSC?
- What are they doing there?
- Where do they study? socialize?
- Where do they want and/or need more seating? and more shade?
- What are their ‘Top 5’ priorities for future improvements?



# WHAT WAS ASKED

## IN THE BSC:



Relax OR Sleep



Attend Events / Performances



Game



Collaborate/Group Study



Study Alone

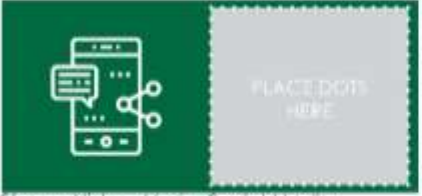

Stream Video, Music, Social Media



Read



Access Technology



Socialize / Hang Out



Meditation / Group Exercise



Eat Lunch



Access Academic Resources & Tutoring



Retail / Shop



Print / Makerspace / Craft



Outdoor ASI / Community Events



Morning Coffee



ASI, Clubs, SC Orgs



Use Student Services



IT Services / Help Desk



Other - Write on Sticky Note

## ON A TYPICAL DAY:



## AROUND THE BSC:



Childcare Services



Bookstore



Sit Outdoors



Starbucks



View Art



Marketplace

HOW MUCH TIME DO YOU SPEND IN THE BSC? WHAT DO YOU DO? ●



# STUDENT ENGAGEMENT





**500+**  
**Total Dots Used**  
(in responses to questions)



# DISCUSSION...





# STUDENT COMMENTS



“It’s pretty exciting to see that **our input might actually be implemented** in the university’s **future plans**.



“I think it’s cool that you’re **exploring** some of the **spaces around the BSC**, like the Childcare Services building. It’s really important to cater to **students’ and staff’s familial needs** as well.”



# **RESULTS:** Bronco Student Center



# BSC PRIORITIES SURVEY

## BSC IMPROVEMENT

1. more / better  
food options  
+ more  
seating/tables  
in the food  
court area

primary identity  
as a  
student center  
with space for  
programs, events  
+ activities

## BSC IMPROVEMENT

1. primary identity  
as a  
student center  
with space for  
programs, events  
+ activities

2. conference  
center for  
campus,  
community,  
& industry  
mtgs/events

more / better  
food options  
+ more  
seating/tables  
in the food  
court area

## BSC IMPROVEMENT

1. more / better  
+ variety of  
study spaces  
(individual  
study rooms,  
quiet space,  
informal study  
areas)

2. primary identity  
as a  
student center  
with space for  
programs, events  
+ activities

3. more / better  
food options  
+ more  
seating/tables  
in the food  
court area

## BSC IMPROVEMENT

1. enough space  
for all  
student center  
activities  
(study, social,  
events, etc.)

2. more / better  
study spaces  
(individual  
study rooms,  
quiet space,  
informal study  
areas)

3. more / better  
study spaces  
(individual  
study rooms,  
quiet space,  
informal study  
areas)

## BSC IMPROVEMENT

1. more / better  
study spaces  
(individual  
study rooms,  
quiet space,  
informal study  
areas)

2. more / better  
study spaces  
(individual  
study rooms,  
quiet space,  
informal study  
areas)

3. more / better  
study spaces  
(individual  
study rooms,  
quiet space,  
informal study  
areas)

4. more / better  
study spaces  
(individual  
study rooms,  
quiet space,  
informal study  
areas)



# BSC PRIORITIES SURVEY

## TOP 5



1.

more/better  
+ variety of  
study spaces  
(individual/group  
study rooms,  
quiet space  
informal study)

2.

more / better  
food options  
+ more  
seating/tables  
in the food  
court area

3.

improve  
indoor/outdoor  
connectivity w/  
more/better  
outdoor space  
for study, groups,  
activities

4.

state-of-the-art  
facilities &  
technology  
supporting  
instruction &  
events/activities

5.

expand types  
of activity &  
socializing  
offerings  
(gaming, bowling,  
arcade, movie  
theater, etc.)



# BSC USE & ACTIVITIES - SUMMARY

## IN THE BSC:



Relax OR Sleep



Attend Events / Performances



Game



Collaborate/Group Study



Study Alone

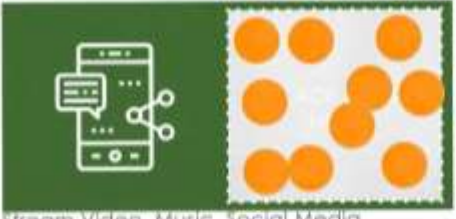

Stream Video, Music, Social Media



Read



Access Technology



Socialize / Hang Out



Meditation / Group Exercise



Eat Lunch



Access Academic Resources & Tutoring



Retail / Shop



Print / Makerspace / Craft



Outdoor ASI / Community Events



Morning Coffee



ASI, Clubs, SC Orgs



Use Student Services



IT Services / Help Desk



Other - Write on Sticky Note

## ON A TYPICAL DAY:

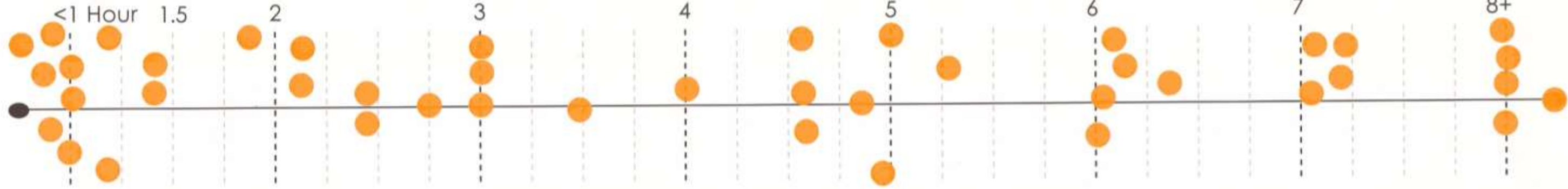

## AROUND THE BSC:



Childcare Services



Bookstore



Sit Outdoors



Starbucks



View Art



Marketplace



# ON A TYPICAL DAY, TIME (IN HOURS) SPENT AT BSC?

While about 1 in five spends less than 2 hrs/day at the BSC, half said they spend half their day (4 hrs or more) there.

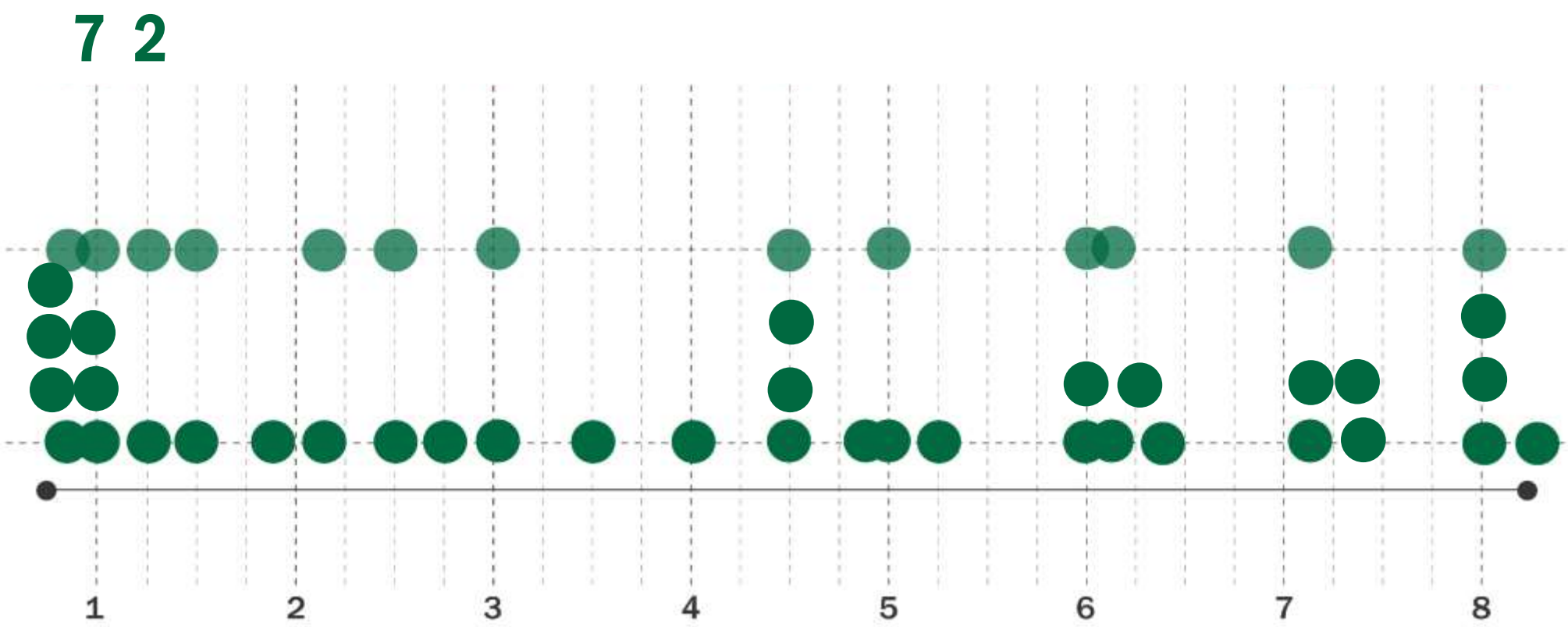



# BSC: WHERE DO YOU STUDY? SOCIALIZE?

- STUDY
- SOCIALIZE

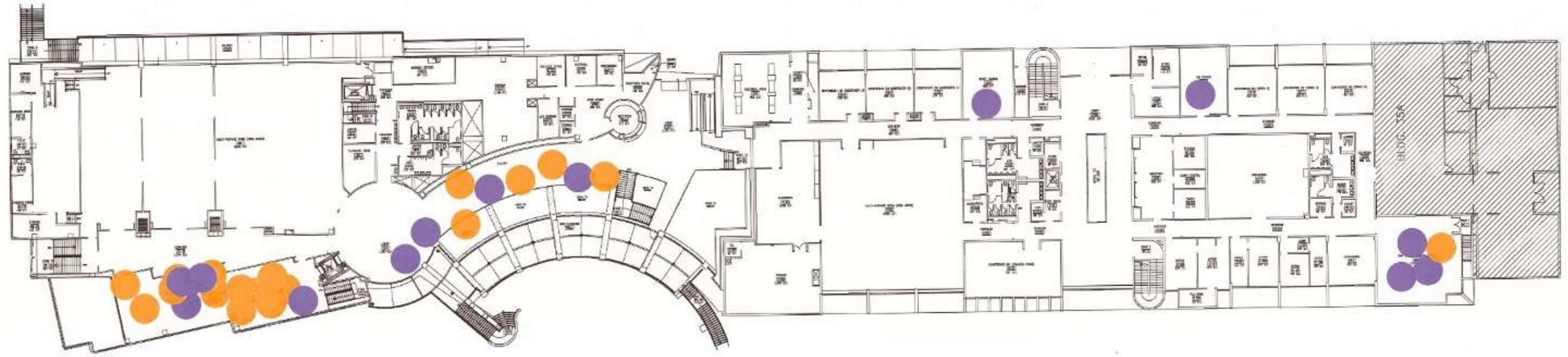

2ND FLOOR



GROUND FLOOR



# FAVORITE PLACE TO STUDY IN THE BSC?

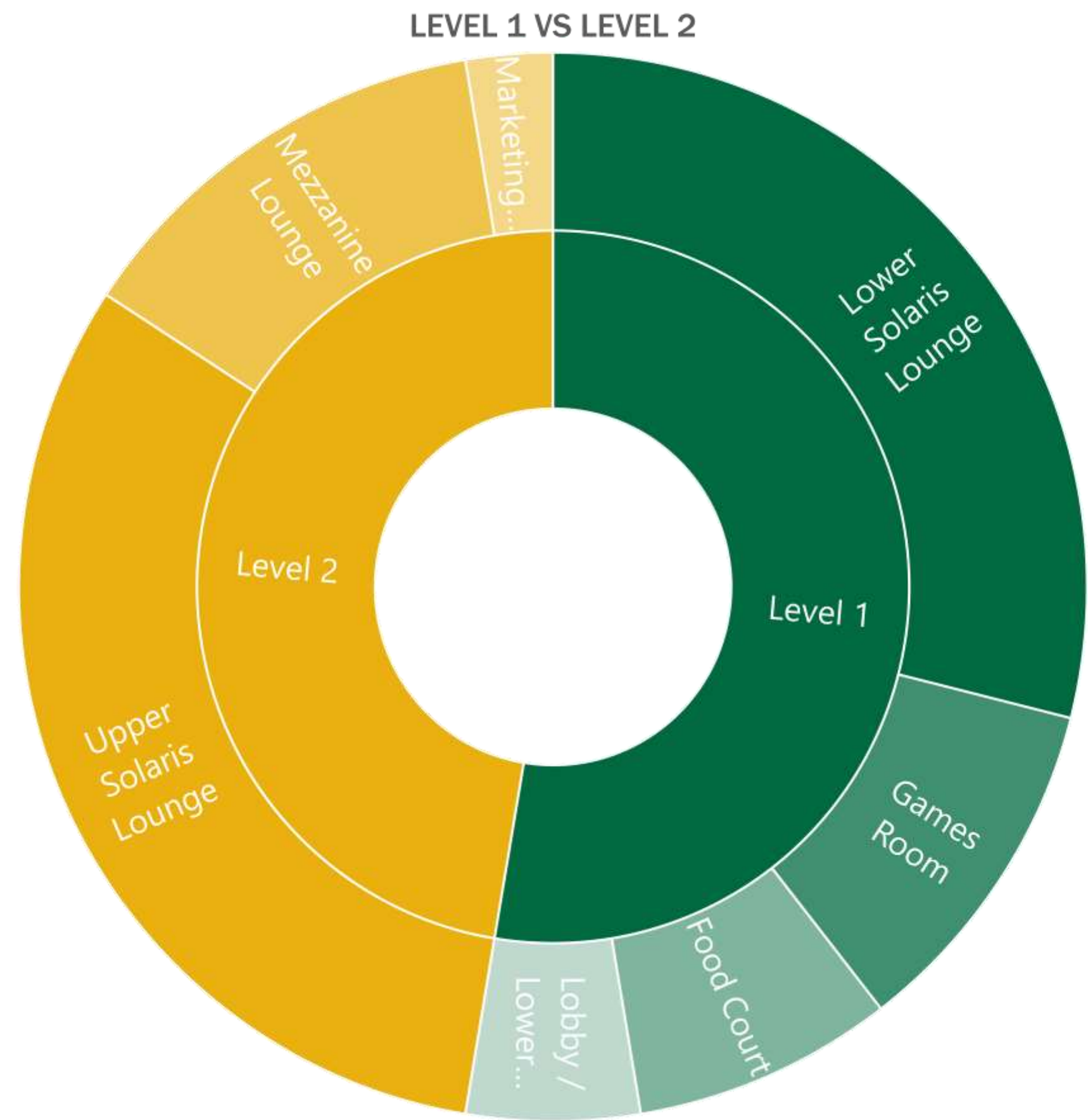

**Top choice is the Upper + Lower Solaris Lounges which demonstrate that students like studying in the areas designed for studying, more than in busier/noisier social areas**

 **LEVEL 2**

 **LEVEL 1**



# FAVORITE PLACE TO SOCIALIZE IN THE BSC?

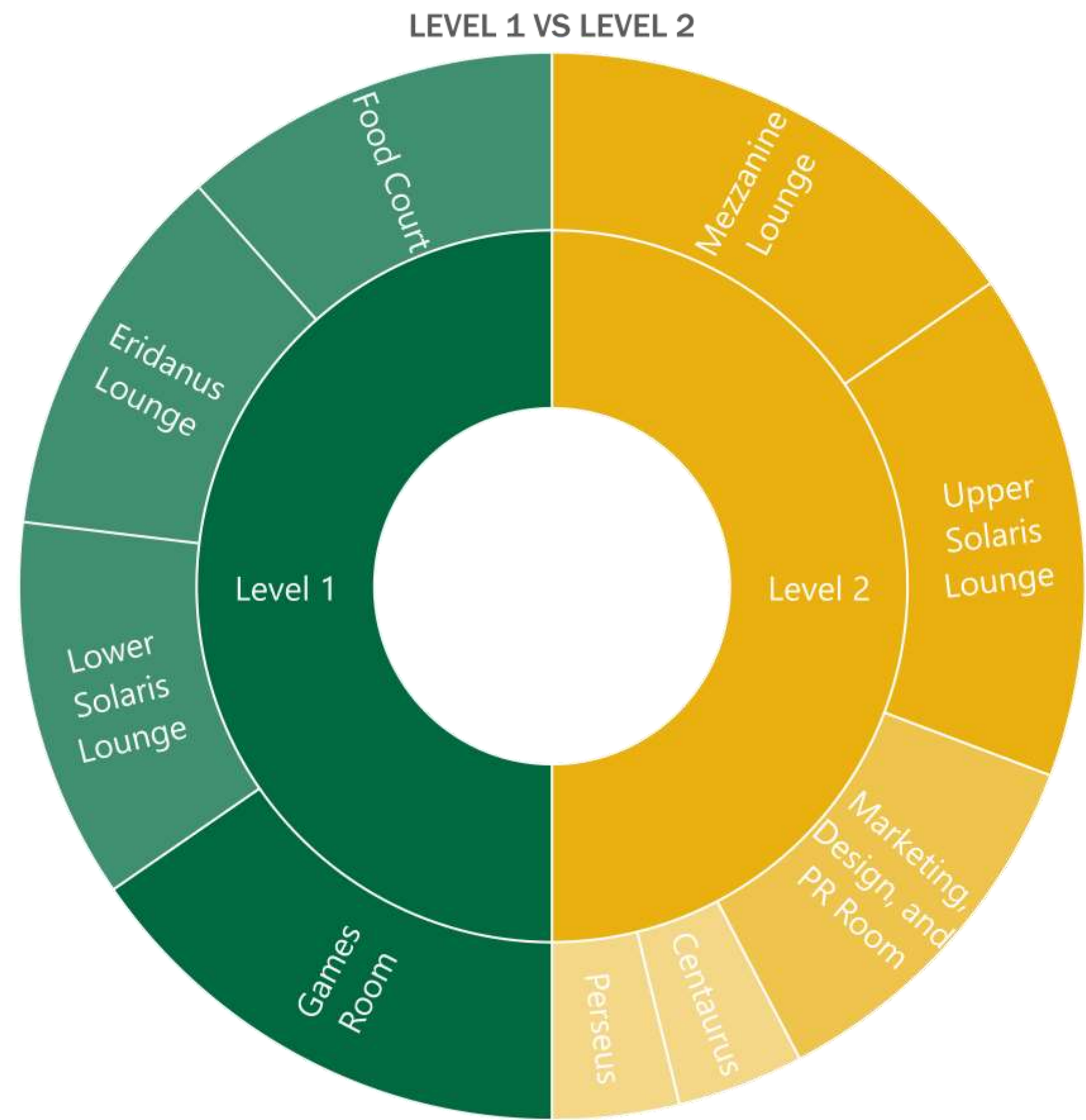

**Socializing is more distributed throughout the BSC, but includes the Solaris Lounges. We heard a lot of discussion about conflicts in these areas, with groups being ‘shushed’ even when working on an assignment.**





# BSC: ADDITIONAL SEATING

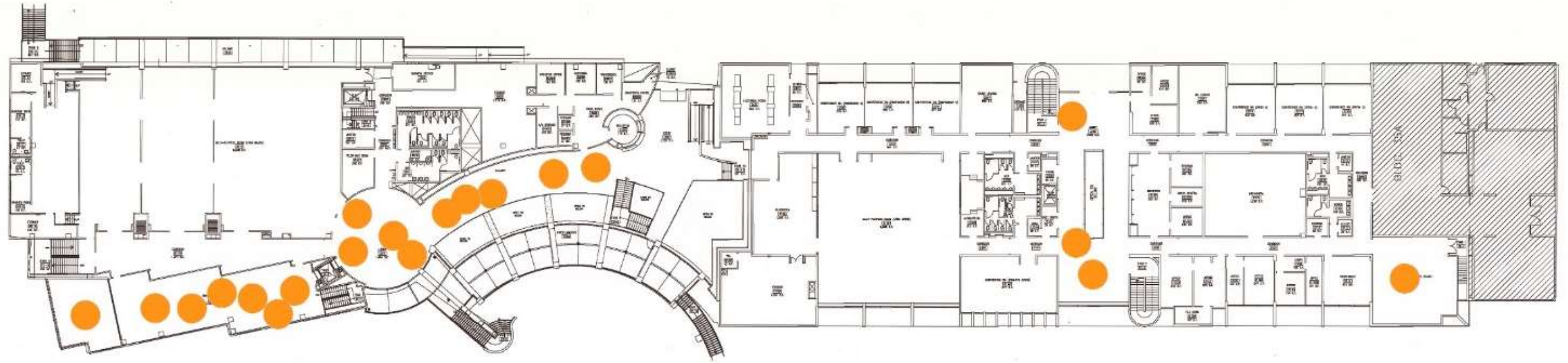

2ND FLOOR



GROUND FLOOR



# AROUND THE BSC: NEEDS MORE SHADE





# ACTIVITIES AT THE BSC?

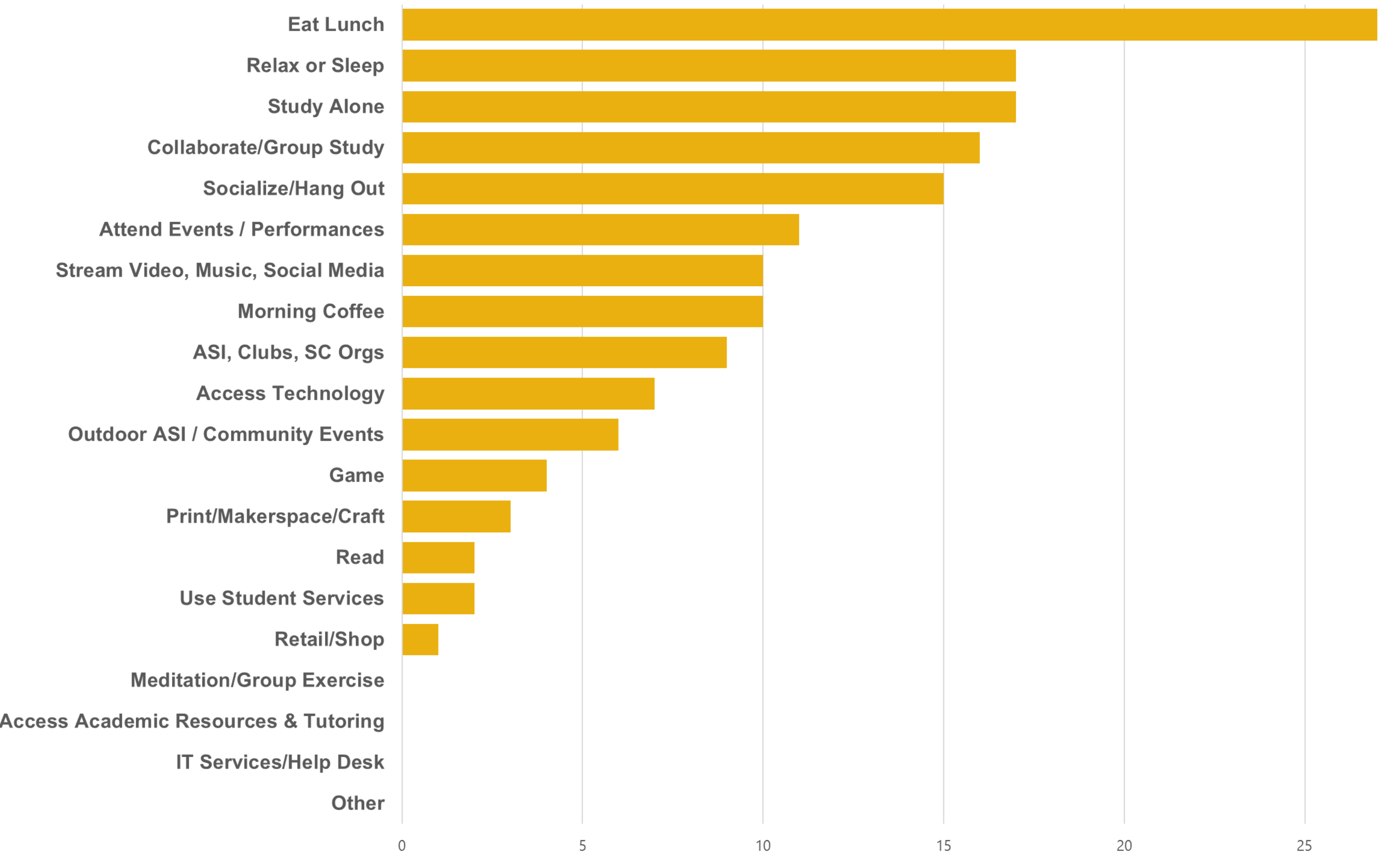



# ACTIVITIES AROUND THE BSC?

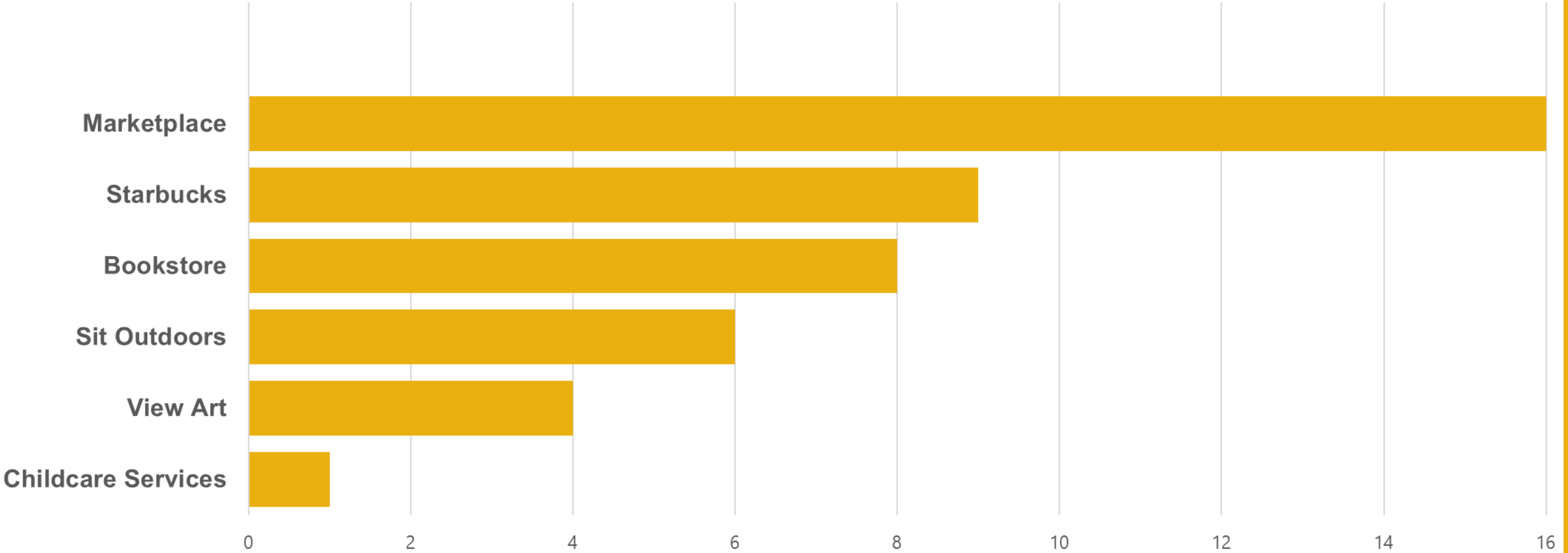



# MOST IMPORTANT FUTURE ACTIVITIES

TOP 5 RESPONSES:



27

EAT LUNCH



17

RELAX OR SLEEP



17

STUDY ALONE



16

COLLABORATE / GROUP STUDY



15

SOCIALIZE / HANGOUT



# MOST IMPORTANT FUTURE ACTIVITIES

**BOTTOM 5 RESPONSES:**



2

USE STUDENT SERVICES



1

RETAIL / SHOP



0

MEDITATION / GROUP EXERCISE



0

ACCESS ACADEMIC RESOURCES & TUTORING



0

IT SERVICES / HELP DESK



# MOST IMPORTANT FUTURE ACTIVITIES AROUND BSC

HIGHEST TO LOWEST PRIORITY:



16

MARKETPLACE



9

STARBUCKS



8

BOOKSTORE



6

SIT OUTDOORS



4

VIEW ART



1

CHILDCARE SERVICES



**RESULTS:** overall campus



# CAMPUS-WIDE

## Study:

- Library
- BSC
- near classes

## Socialize:

- BSC
- Campus Center
- near food
- gardens, quads, courtyards, open spaces

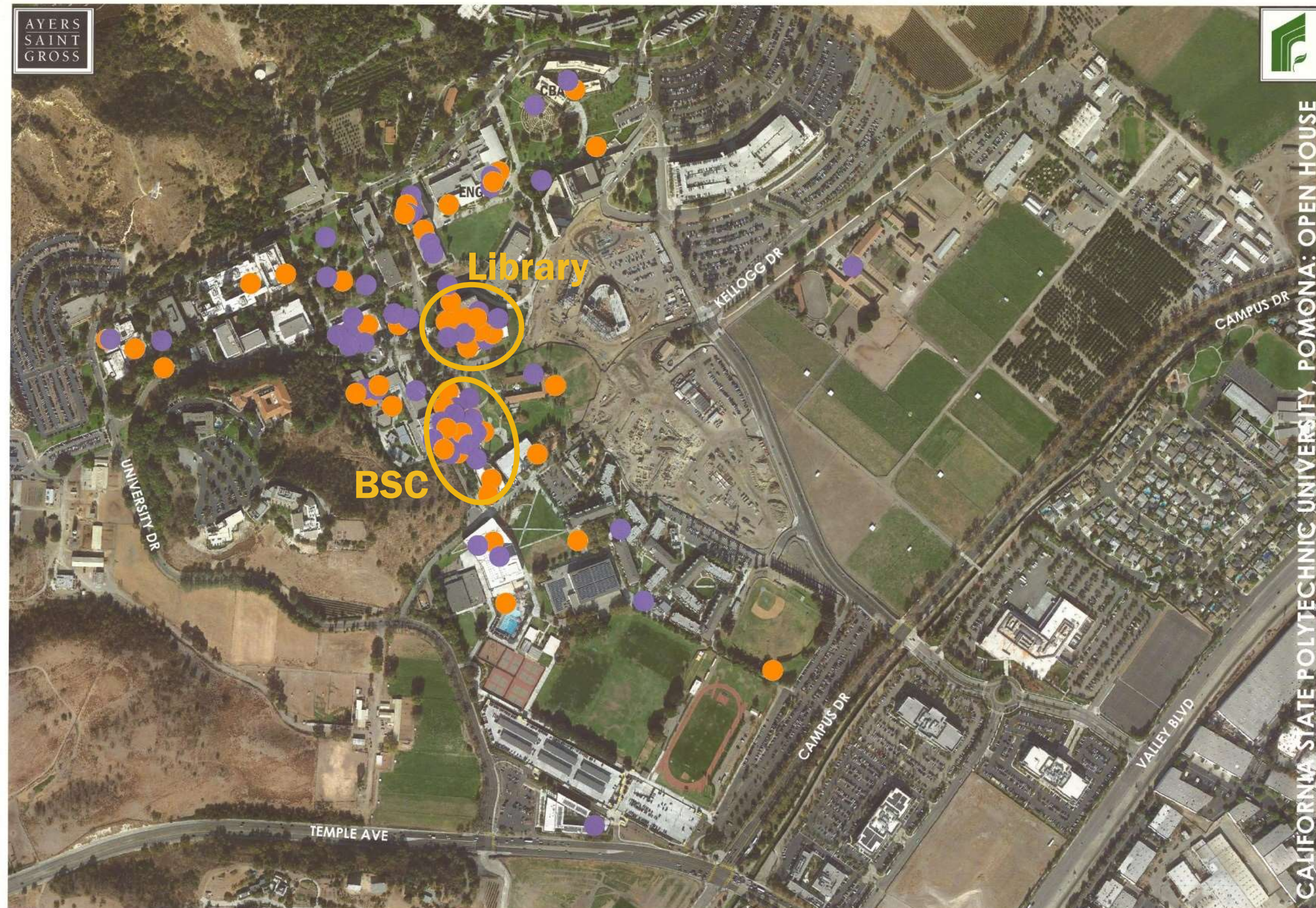

WHERE DO YOU STUDY? SOCIALIZE?

STUDY ●

SOCIALIZE ●



# FAVORITE PLACE TO STUDY?

RESPONSES:

FAVORITE PLACE TO STUDY ON CAMPUS

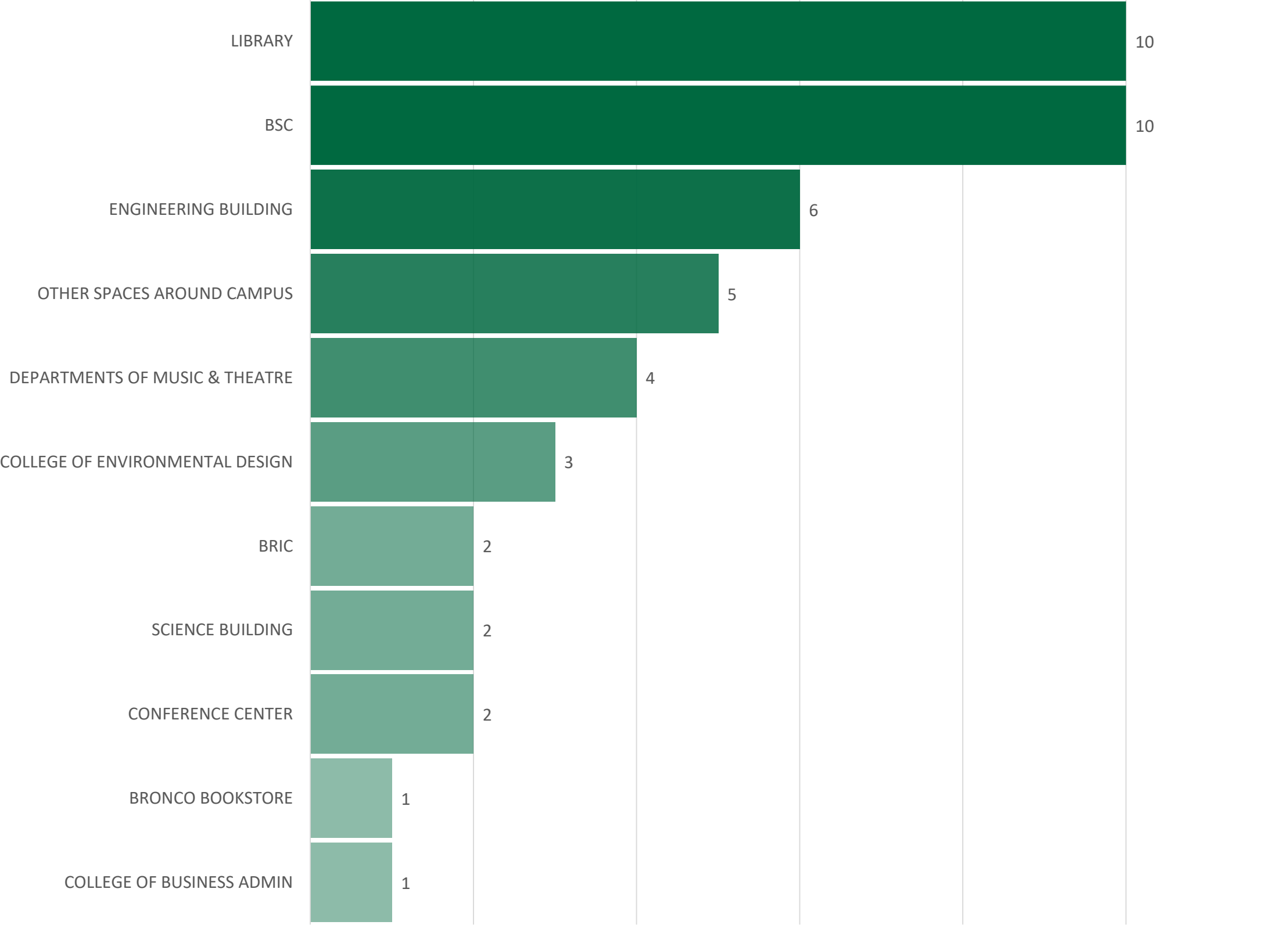



# FAVORITE PLACE TO SOCIALIZE?

RESPONSES:

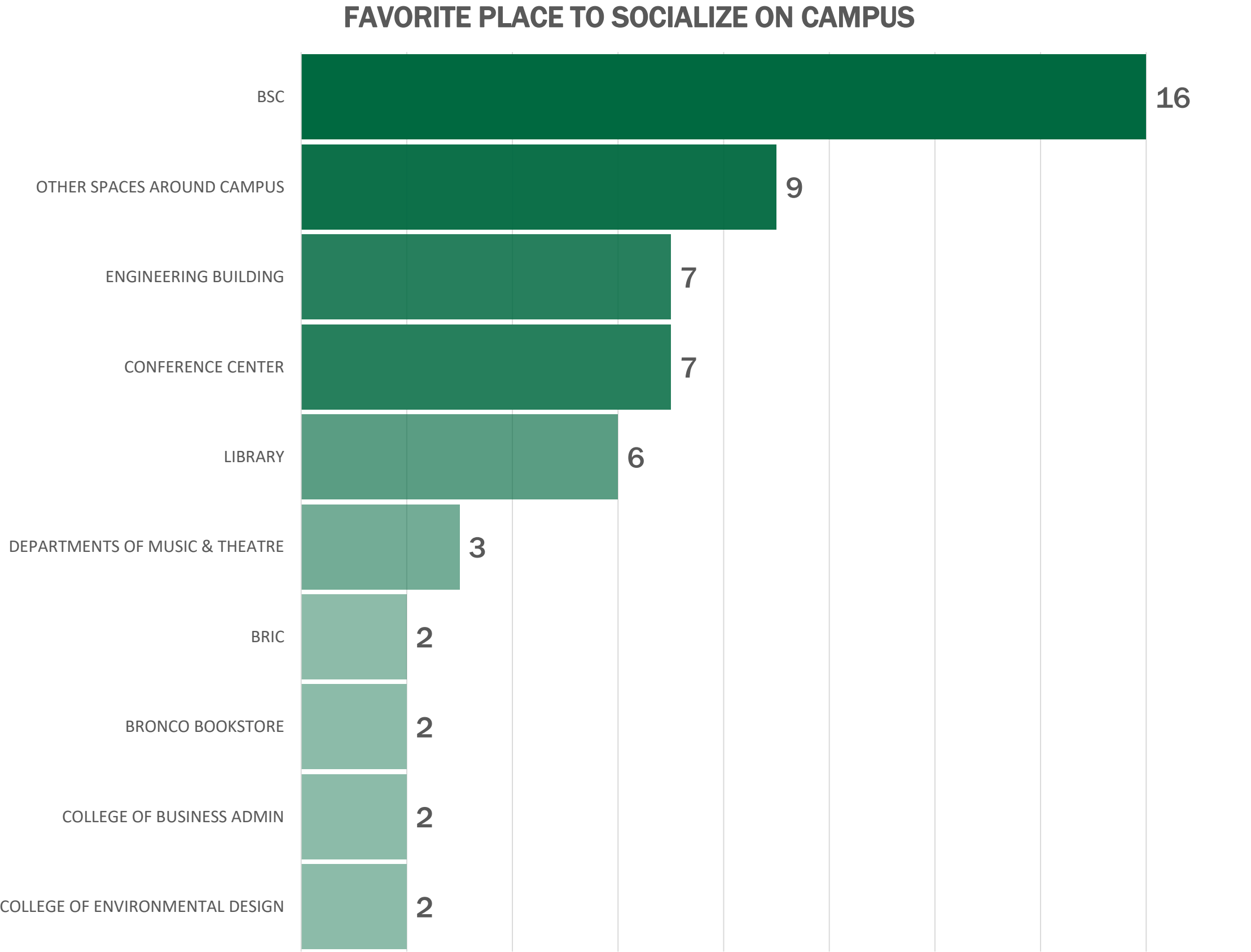



# CAMPUS-WIDE

## Seating:

- Engineering Quad
- University Park
- Library
- University Quad
- BRIC Commons
- In all quads, courtyards and open spaces
- Bus stops



MORE SEATING, PLEASE!

SEATING 



# CAMPUS-WIDE

## Shade:

- BRIC Commons
- Engineering Quad
- University Park
- In quads and open spaces
- Bus stops
- Major pathways

## Comments:

- Replace trees!





# ADDITIONAL COMMENTS

---

## **SOME ADDITIONAL CONCERNS WERE:**

- **More seating and shade by CLA shuttle stop.**
- **Shade needed for bike paths and pedestrians.**
- **More accessible stairs on west side of campus near College of Environmental Design.**
- **More seating and shade at bus stop near Temple Ave Parking structure and Cal Poly Pomona Parking Structure 2.**
- **More seating and shade near stop for Village Shuttle.**
- **Re-plant trees in areas around the Engineering building, the Library, and the Conference Center.**



# **RESULTS:** visual preferences



# SHADE/SEATING PREFERENCES

+11



LOVE/HATE

LOVE ●

HATE ●



# HATE!





# SHADE/SEATING PREFERENCES

## #1

- charging outlets
- solar powered
- wifi booster
- shade built-in
- plaza + landscape
- benches not chairs
- work surface / table
- for groups or individuals





# SEATING PREFERENCES



- lawn (but not wet)
- choices, versatile, flexible
- benches
- shaded
- landscape + hardscape
- work surface / table
- groups or individuals





# SHADE PREFERENCES

- shades a larger area
- shapes a space
- plaza + landscape
- work surface / table
- groups or individuals

#3



#3





# **CONCEPTS:** Seating-Shade Pilot Project



# BSC: ADDITIONAL SEATING



# BSC: ADDITIONAL SHADE

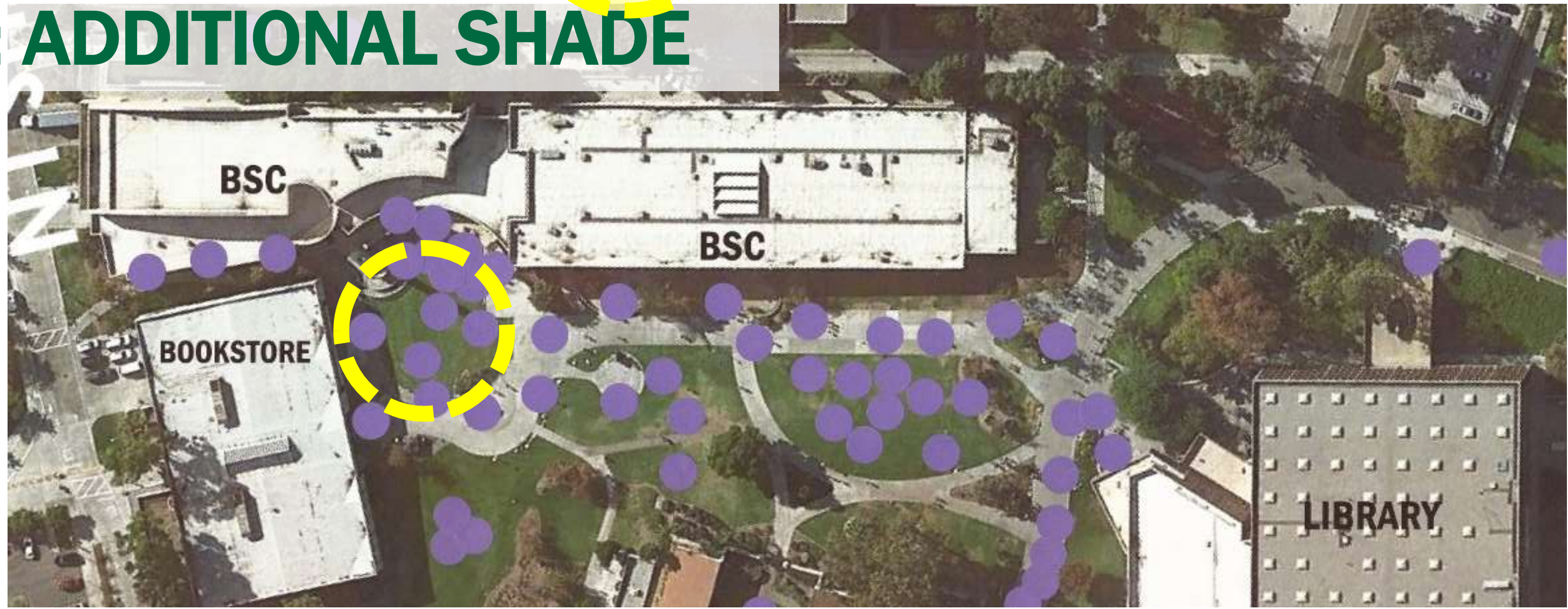



# BSC pilot project options



Try benches instead of seats, and a more durable table top material?



# BSC pilot project options



- Add more of the same table currently on the back side of the BSC
- Locate around the grass circle (near existing tables, but in sunny area)
- Expensive per seat, not a creative leap, table tops had issues
- Still needs a power source nearby



Altair  
87"x84"



Cygnus  
90" x 84"

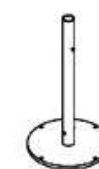

Surface mount



# BSC pilot project options

- Go Table, standing/stool height
- Movable stools
- Solar panel, battery storage (can also have hard-wired power)
- Mix with non-canopy tables?





# BSC pilot project options





# Thank you!

